

Jonathan Walker

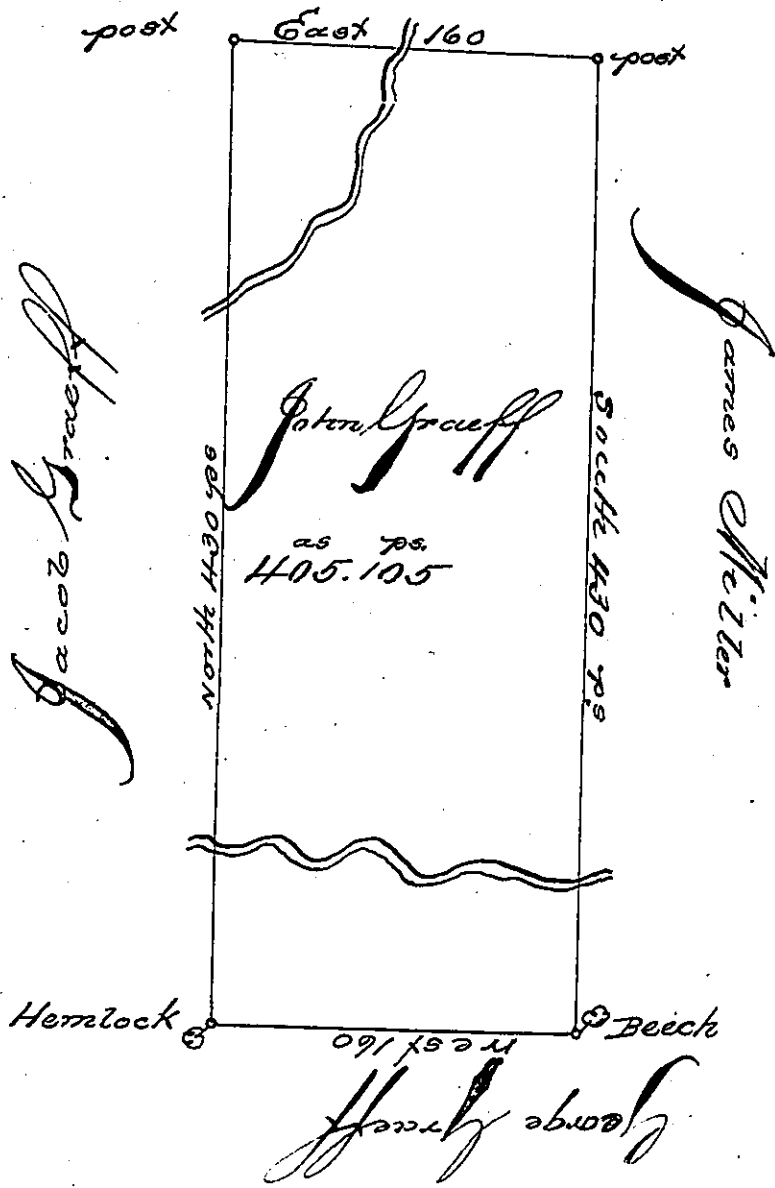

Situate on the waters of Black Lick creek in Wheatfield Township
 Westmoreland County, Containing 405 acres & 105 perches and allowance
 for Roads &c Surveyed for John Graeff the 17th day of November
 1794. on Warrant dated the 3^d day of May 1793.

Daniel Broadhead Esq
 S. G.

James Ross, D. D.

IN TESTIMONY that the above is a copy of the original remaining on file in
 the Department of Internal Affairs of Pennsylvania, made
 conformably to an Act of Assembly approved the 16th day of
 February, 1833, I have hereunto set my Hand and caused
 the Seal of said Department to be affixed at Harrisburg,

this Third day of January 1899

James W. Latta
 Secretary of Internal Affairs.